



Motorized system IL952-S

- Roller blind with motor drive
- New silver anodized aluminium tube \varnothing 47 mm (1.85")
- New 100-250V/50-60Hz - 1/40 ultrasilent electronic motor with integrated radio receiver
- "Headless" motor to reduce the lateral drop of the fabric as much as possible
- 3 preset intermediate positions in the motor: 25% - 50% - 75% of the winding
- Reinforced lateral steel brackets with nylon bracket covers for overhead or wall anchorage
- Aluminium counterweight in three versions
- Aluminium parts: anodized silver, white (RAL9010) or black (RAL9005) finish.
- White, black or grey plastic components
- Trevira CS fabrics are cut with patented "Stabilus cut" ultrasonic welding, while screen fabrics are hot cut.
- The fabric is fixed to the roller by means of a special high-tenacity double-sided adhesive tape
- Assembled to measure and tested individually before packing, ready to install



- OPTIONAL
- Intermediate bracket covers in order to install two or more adjacent rollers that allow for the gap between the fabrics sheets to be reduced as much as possible.
- Brackets for double roller with individual controls

RM952



TECHNICAL FEATURES

Tube

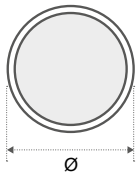

Bracket

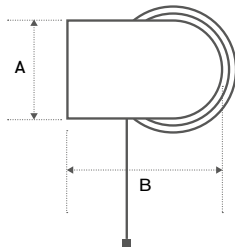

Fabric

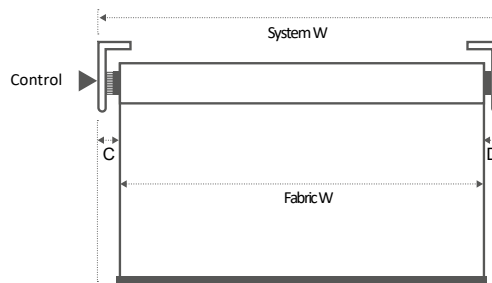

System	Width min - max cm (inch)	Height max cm (inch)	Ø tube mm (inch)	Brackets mm (inch)	fabric reductions				Fabric W mm (inch)
					A mm (inch)	B mm (inch)	C mm (inch)	D mm (inch)	
IL911	52 - 300 (20-1/2" - 118")	360 (141-5/8")	47 (1.85")	70 std. (2.76")	46 (1.81")	69 (2.72")	19 (0.75)	19 (0.75")	System W - 38 System W Less (1.50")

Warning: to ensure a correct fabric take-up the width/height ratio must not exceed 1:4



BOTTOM BARS

Oval

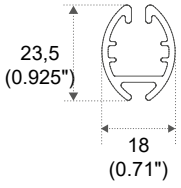

Round



Square

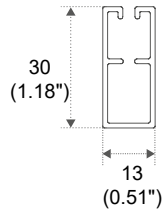

The bottom part of the fabric may be completed with a pocket holding an oval bottom bar or alternatively a flat weight rail on its inside.

Indoor roller blinds

INSTALLATION TYPES

Ceiling

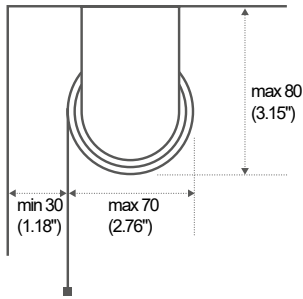

Wall

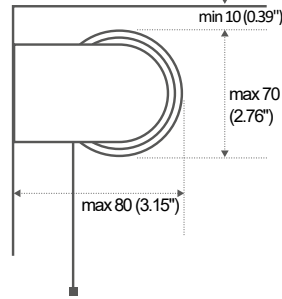

Niche

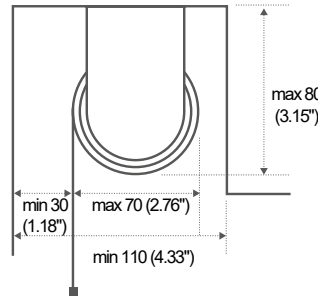

The indicated dimensions refer to a system with maximum take-up.

RM952

tube

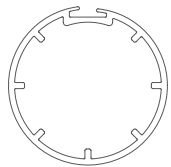

bracket

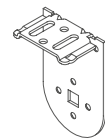

bracket cover



screw cover

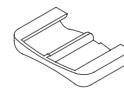

MOTOR



Standard motor

Item	Code	Description	Pair	Speed	Min. system W
SIL 40R 1/40 MV	51161	Electronic radio motor 100-250V/50-60Hz	1 Nm	40 rpm	52 cm (20-1/2")



SYSTEM OPTIONS

Side by side rollers with individual controls

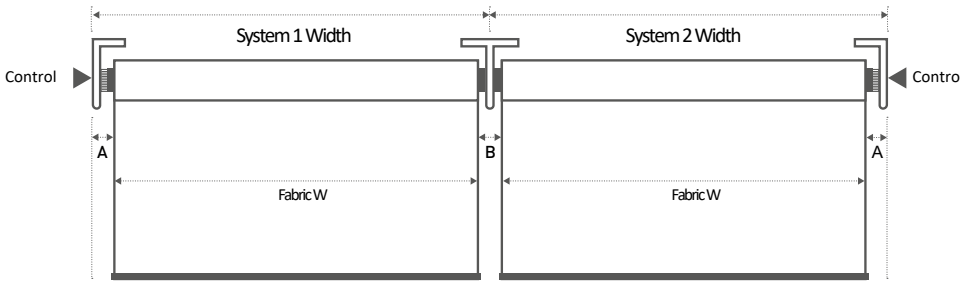

Fabric reductions (mm)

A = 19 (0.75")
B = 32 (1.26")

Fabric W (mm)

System W = 35 (1.38")

The united central bracket cover allows the gap between the canvas sheets to be reduced as much as possible.

intermediate bracket cover

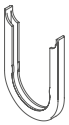

Bracket for double roller

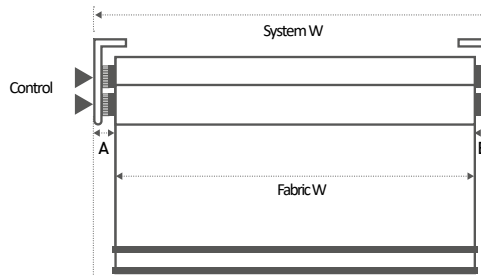
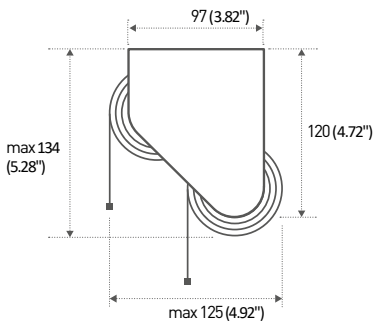

Fabric reductions (mm)

A = 23 (0.91")
B = 15 (0.59")

Fabric W (mm)

System W = 38 (1.50")

The double roller bracket allows the installation of two rollers with individual controls.

The brackets can be anchored either to the ceiling or the wall.



RM952

bracket

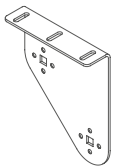

Double roller

sum of both rollers

FEASIBILITY CHART BY WEIGHT CATEGORY (Motor 1 / 40)

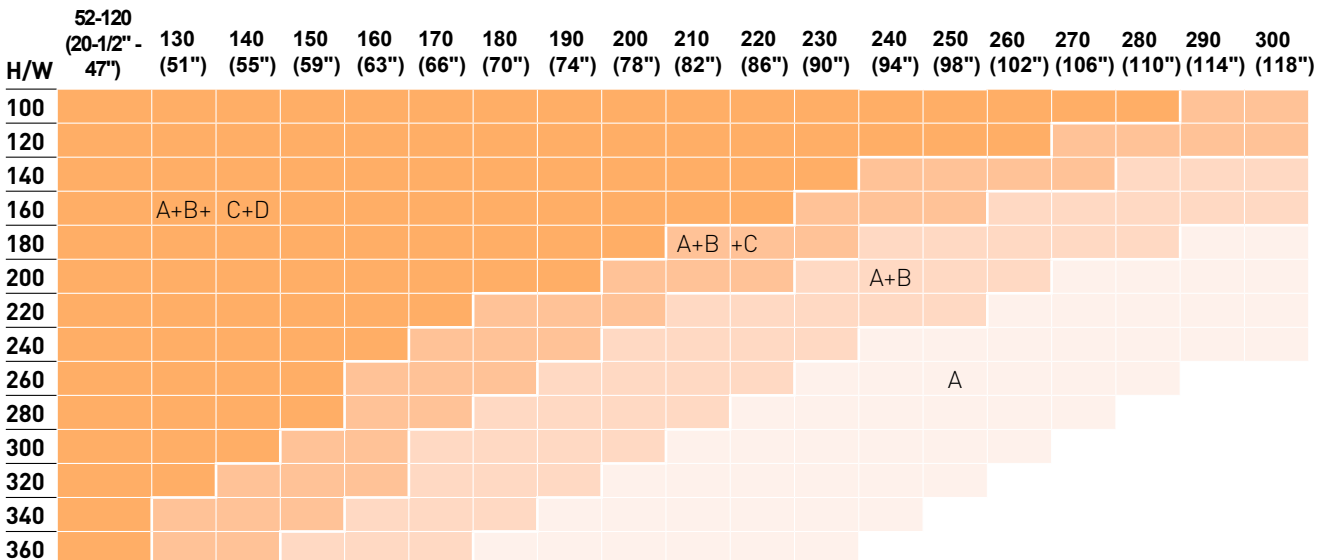



SYSTEM FABRICS CHART

Fabric		Price range	Weight cat.	Max W	Max H std supp. 70
Bamboo Designscreen		4	B	225 / 88"	190 / 74"
Colorvira 1		1	A	300 / 118"	360 / 141"
Colorvira 1 Nature		1	A	300 / 118"	360 / 141"
Colorvira 2		2	A	300 / 118"	360 / 141"
Colorvira 2 Nature		3	A	300 / 118"	360 / 141"
Denim Designscreen		4	A	295 / 116"	360 / 141"
Flexy Officescreen 1% - 3%		3	B	300 / 118"	360 / 141"
Flexy Officescreen 5% - 10%		3	B	300 / 118"	360 / 141"
Flexy Officescreen Metal		6	B	280 / 110"	360 / 141"
Glass Metal Screen Metal		6	A	235 / 92"	360 / 141"
Gloss Designscreen		3	B	295 / 116"	360 / 141"
Light Officescreen Metal		6	B	280 / 110"	360 / 141"
Light Officescreen RR		3	C	295 / 116"	330 / 129"
Linenstyle 1		1	A	300 / 118"	360 / 141"
Linenstyle 2		2	A	300 / 118"	360 / 141"
Multi Officescreen 2%		3	C	295 / 116"	290 / 114"
Multi Officescreen 4%		3	B	295 / 116"	350 / 137"
Nature Designscreen		5	D	245 / 96"	360 / 141"
Night O.		2	C	180 / 70"	360 / 141"
Nightscreen		6	D	245 / 96"	350 / 137"
Oscurama 5.1 - H. 240		3	B	235 / 92"	360 / 141"
Oscurama 5.1 - H. 300		3	B	295 / 116"	360 / 141"
Oscurama 9.1		4	B	295 / 116"	360 / 141"
Relife Screen Metal		5	A	235 / 92"	360 / 141"
Sealife Screen Metal		5	A	275 / 108"	360 / 141"
Soltis 86		5	B	262 / 103"	360 / 141"
Soltis 92		6	B	262 / 103"	360 / 141"
Style Officescreen Metal		4	A	280 / 110"	360 / 141"
Superscreen		4	C	280 / 110"	250 / 98"
Wood Designscreen		6	D	300 / 118"	190 / 74"

RM952

